

Installation instructions for the SOS Remote Microphone

The remote microphone will allow you to put the microphone up to 50 feet away from the SOS 12 unit. The SOS 12 must be purchased separately to use the remote mic. Allowing the SOS unit to be installed inside a cabinet, in side the guard shack or any other out of the way location.



1. Remove the face plate of the SOS Remote Mic.
2. Find a location INSIDE the fence, up on a pole or another location that individuals can not easily get to. Do not put the unit inside the gate operator enclosure or next to any noisy machinery that will interfere with the sensor picking up the sound of the siren.
3. Using the screws provided, mount the SOS Remote Mic with the microphone facing the oncoming emergency vehicle. The enclosure has four pre-drilled holes for mounting.

NOTE: If mounting the SOS onto metal, do not allow metal shaving to remain in the enclosure.



4. Install the SOS 12 unit—see SOS 12 installing instructions
5. Run a two wires 18—22 AWG stranded (not included) from the terminal strip on the Remote Mic to the terminal strip on the SOS 12 board. Do not exceed 50 feet.
6. Unplug the microphone from the SOS 12 board.

Remote Mic

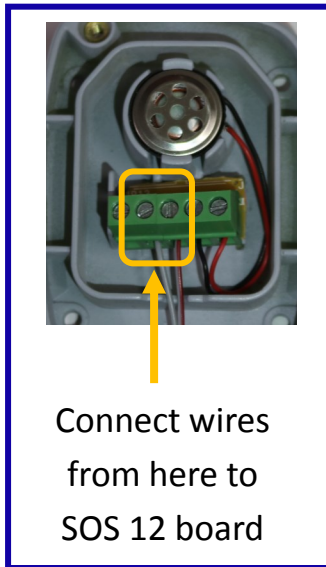

SOS 12 Board

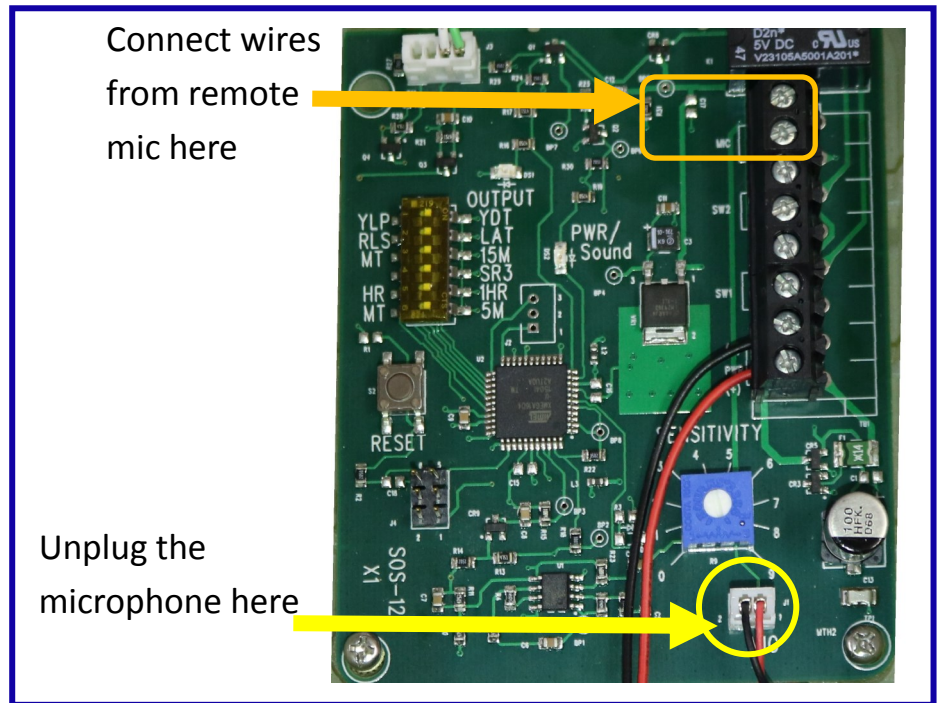

TEST UNIT

7. Begin testing by turning the sensitivity dial clockwise to setting 8.5.
8. Using the Yelp Siren CD provided, or download the MP3 yelp off our website www.sosgate.com onto your mobile device, play it at the loudest volume setting. Hold your device close to the microphone, the PWR/Sound light should come on solid, and the output light should come on as the gate opens within 3 seconds.
9. Test the unit now with a live siren. You want to have the sensitivity setting as low as possible, but still able to open the gate with a live siren. The main reason for the SOS not triggering the gate open is, that they are using a different siren sound than “YELP” or they are only leaving their siren on for 1-2 seconds.
10. Have the emergency responder sound their “YELP” siren. If the gate does not open within 3 seconds, verify that the PWR/Sound light is coming on solid. If PWR/Sound light is solid and the gate still does not open turn up the sensitivity. The output light must come on before an open trigger is sent to the gate operator.

Note: Every time the siren is interrupted or changed the digital processor begins the process over again, this internal reset can take several seconds.